

REV	MODIFICATION	DRAW	DATE
A.00	新版发行		20201125

防水圈T=1.5

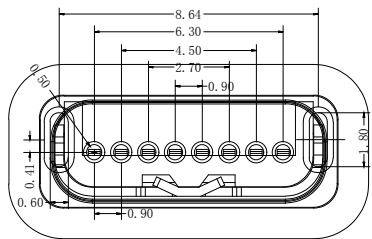
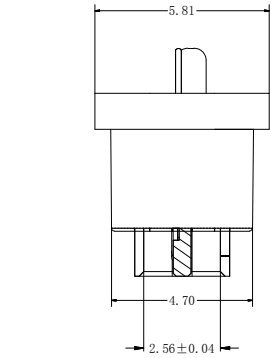
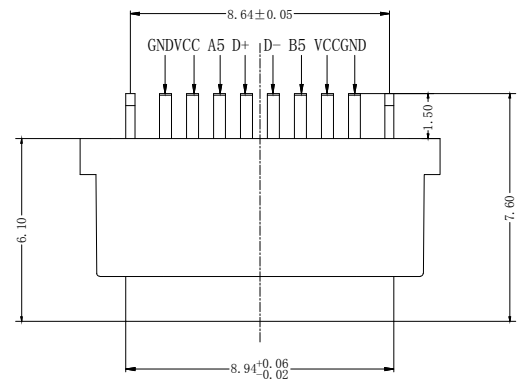

RECOMMENDED P.C.B. LAYOUT
TOLERANCE UNSPECIFIED ±0.05mm

- NOTES:**
SPECIFICATION:
 1. CURRENT RATING: 3.0A MAX
 2. VOLTAGE: 100 VAC
 3. TEMPERATURE RANGE: -30°C~+85°C
 4. CONTACT RESISTANCE: 40 MILLIONHM MAX
 5. INSULATION RESISTANCE: 100 MEGOHMS MIN
 6. INSERTION FORCE: 5N-20N
 7. UNMATING FORCE: 3N-20N
 8. DURABILITY: 10000 CYCLES
 9. WATER PROOFNESS: THIS PRODUCT IS BASED ON IPX7.

PIN ASSIGNMENT:

PIN NO	A1&B12	A4&B9	A5	B5	A9&B4	A12&B1
SIGNAL NAME	GND	VBUS	CC1	CC2	VBUS	GND
PCB PAD NO.	C1	C2	C3	C4	C5	C6

PEUE®

LINEAR	ANGLE
.X 0.25	.X 5°
.XX 0.25	.X 2°
.XXX 0.25	.XX 5°

广东省振端实业有限公司
GuangDong Zhenduan Industrial Co.,Ltd

产品名称: (PARTNAME) 规格型号: (SPEC) TYPE-C 6Pin 立式插板防水8级L=6.1

校对: APPRO.BY	厂内料号: (PARTNO)	客户料号: (PARTNO)	数量: (CNUM)
设计: DESIGN.BY			1
绘图: DOWG.BY	单位: UNIT: mm	比例: SCALE: N/A	张数: PAPERS: 1/1
		版本: RVE: A.00	